

FEATURES

- Breakdown voltage between contacts and coil: 2000V
- Surge withstand between contacts and coil: 2500V
- High contact capacity: 2A / 30VDC
- UL and CUL approval, File No. E179936

CONTACT DATA

Contact form	2C
Max. contact resistance	50mΩ
Contact rating (resistive)	2A/30VDC0.5A125VAC
Max. switching current	2A
Max. switching power	60W
Max. switching voltage	220VDC/250VAC
Max. switching load	0.01mA/10mV (Reference value)
Contact material	Silver alloy / Gold clad

CHARACTERISTICS

Insulation resistance	Min. 1000MΩ min (at 500VDC)
Dielectric strength	
- Between coil and contacts	2000VAC (1 min.)
- Between open contacts	1000VAC (1 min.)
- Between contact sets	1500VAC (1 min.)
Surge withstand voltage	
- Between coil and contacts	2500V (FCC part 68)
- Between open contacts	1500V (FCC part 68)
Operate time (set & reset time)	Max. 4 ms
Release time	Max. 4 ms
Vibration resistance	10 – 55Hz, Double amplitude, Functional: 3.3mm Survival: 5mm
Shock resistance	Functional: 750m/s ² 11ms Survival: 1000m/s ² 6ms
Relative humidity	35% - 85% RH
Ambient temperature	-40°C to +85°C
Life expectancy	
- Electrical	5 x 10 ⁵ operations (1A / 30VDC) 1 x 10 ⁵ operations (2A/30VDC)
- Mechanical	1 x 10 ⁸ operations

COIL SPECIFICATIONS - 1. Single side stable

Nominal voltage (VDC)	Coil voltage VDC(Max.)	Pick-up voltage VDC(Max.)	Drop-out voltage VDC(Min.)	Coil resistance ($\Omega \pm 10\%$)	Power consumption (W)
1.5	2.2	1.13	0.2	16	0.14
2.4	3.6	1.8	0.24	41.1	0.14
3	4.5	2.25	0.3	64.3	0.14
4.5	6.7	3.38	0.45	145	0.14
5	7.5	3.75	0.5	178	0.14
6	9	4.5	0.6	257	0.14
9	13.5	6.75	0.9	579	0.14
12	18	9	1.2	1028	0.14
24	36	18	2.4	4114	0.14
48	5.6	36	4.8	8533	0.27

2. 1 Coil Latching

Nominal voltage (VDC)	Coil voltage VDC (Max.)	Set/Reset voltage VDC(Max.)	Coil resistance ($\Omega \pm 10\%$)	Power consumption(W)
1.5	2.7	1.13	22.5	0.1
2.4	3.6	1.8	58	0.1
3	4.5	2.25	90	0.1
4.5	6.7	3.38	202.5	0.1
5	7.5	3.75	250	0.1
6	9	4.5	360	0.1
9	13.5	6.75	810	0.1
12	18	9	1440	0.1
24	36	18	5760	0.1

3. 2 Coil Latching

Nominal voltage (VDC)	Coil voltage VDC (Max.)	Set/Reset voltage VDC(Max.)	Coil resistance ($\Omega \pm 10\%$)	Power consumption(W)
1.5	2.2	1.13	16	0.14
2.4	3.6	1.8	41.2	0.14
3	4.5	2.25	64.3	0.14
4.5	6.7	3.38	145	0.14
5	7.5	3.75	178	0.14
6	9	4.5	257	0.14
9	13.5	6.75	579	0.14
12	18	9	1028	0.14
24	36	18	4114	0.14

ORDERING INFORMATION

ME-5	-	L1	-	12	-	SA
Model No.	Sort		Coil Voltage		Foot Pin	
ME-5	Nil: Single side stable L1: 1 coil latch L2: 2 coil latch		3VDC – 24VDC		Nil: PCB Type, SA: SA Type SL: SL Type, SS: SS Type	

Dimensions(unit:mm)
Tolerance:±0.3

1.Single side stable and 1 coil latching type
Standard PC board type

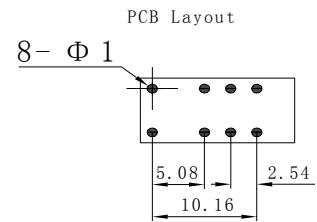
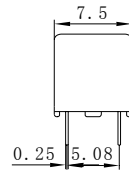
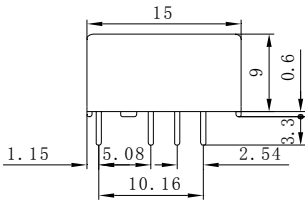

Single Stable & 1 coil latching

SA Type

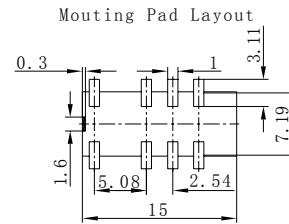
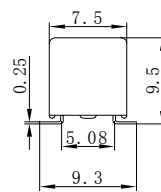
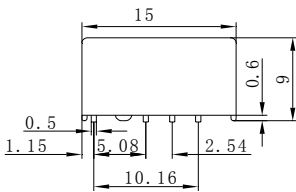

SL Type

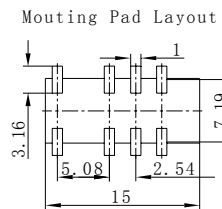
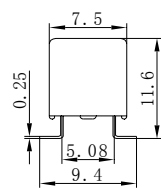
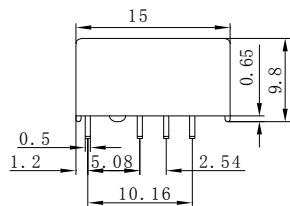

SS Type

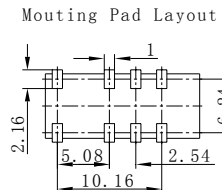
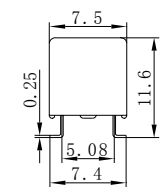
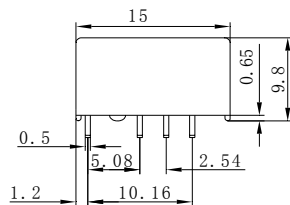

Schematic (Bottom view)

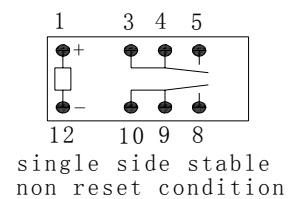
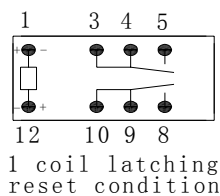

2. Coil latching type

Standard PC board type

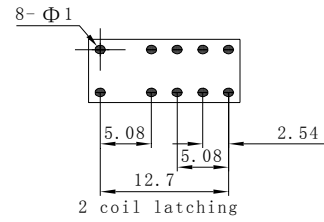
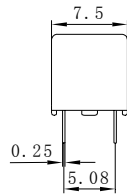
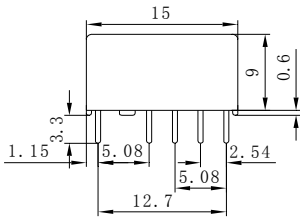

SA Type

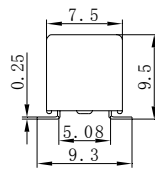
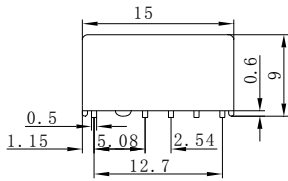

Mouting Pad Layout

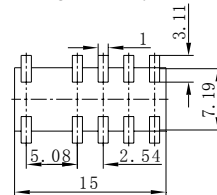

SL Type

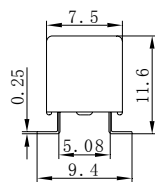
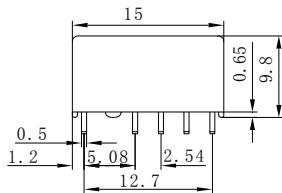

Mouting Pad Layout

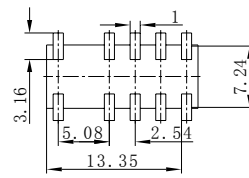

SS Type

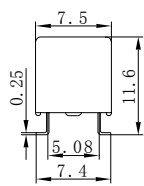
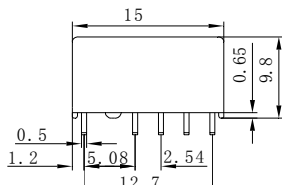

Mouting Pad Layout

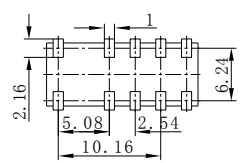

Schematic (Bottom view)

