

DIRECTION OF ROTATION

UNIT: MILLIMETERS

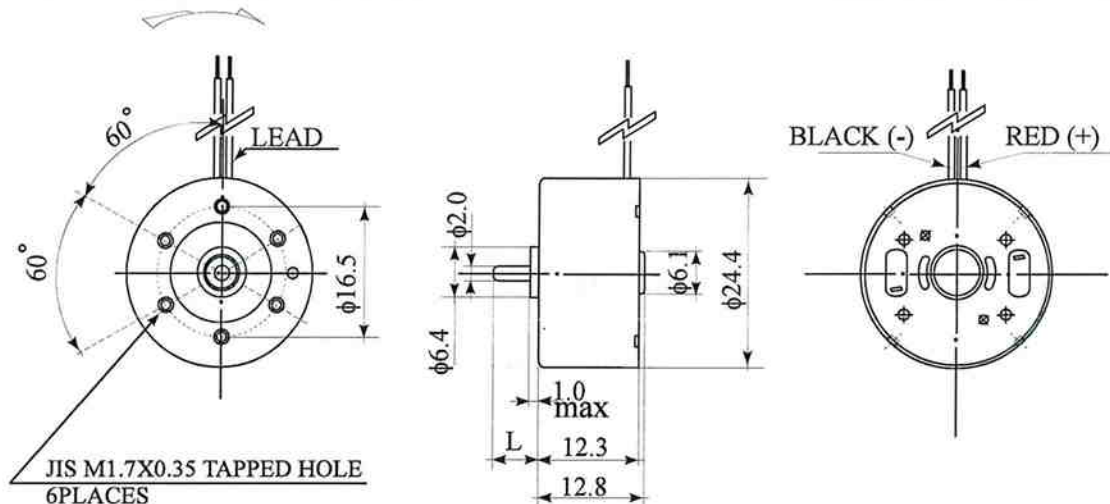

$$L = 10.5 / 7.1 / 3.5$$

WEIGHT: 22g (APPROX)

MODEL	VOLTAGE		NO LOAD		AT MAXIMUM EFFICIENCY				STALL		
	OPERATION RANGE	NORMINAL	SPEED	CURRENT	SPEED	CURRENT	TORQUE		TORQUE		CURRENT
			rpm	A	rpm	A	mN-m	g-cm	mN-m	g-cm	A
RF-300C-14270	0.5~4 V	1.9 V CONSTANT	3500	0.03	2600	0.12	0.37	3.8	1.75	17.8	0.43
RF-300C-11400	1~3V	3V CONSTANT	3000	0.017	2250	0.07	0.42	4.3	2.2	22	0.3
RF-300C-11440	0.7~5.0 V	2 V CONSTANT	2200	0.02	1500	0.06	0.27	2.8	1.15	11.7	0.2