

PANEL MOUNT DC JACKS

No.MJ-40

PANEL MOUNT DC JACK (Center Pin : 2 φ mm)

No.MJ-41

PANEL MOUNT DC JACK (Center Pin : 2.35 φ mm)

No.MJ-42

PANEL MOUNT DC JACK (Center Pin : 1.65 φ mm I.D. : 4.4 φ mm)

JSAJ 2 (DC 3.15V~6.3V)

No.MJ-43

PANEL MOUNT DC JACK (Center Pin : 1.65 φ mm I.D. : 5.15 φ mm)

JSAJ 3 (DC 6.3V~10.5V)

No.MJ-44

PANEL MOUNT DC JACK (Center Pin : 1.3 φ mm I.D. : 3.4 φ mm)

No.MJ-45

PANEL MOUNT DC JACK (Center Pin : 1.3 φ mm I.D. : 3.8 φ mm)

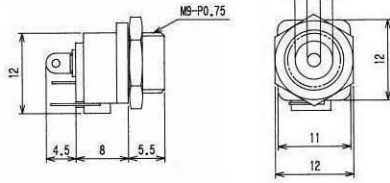

DC INLINE JACK

No.MJ-077N

(5.5 φ × 2.1 φ mm)

No.MJ-078N

(5.5 φ × 2.5 φ mm)

No.MJ-095N

(center pin : 0.65 φ mm)

JSAJ 1 (DC 3.15VMax)

No.MJ-096N

(center pin : 1.65 φ mm

I.D. : 4.4 φ mm)

JSAJ 2 (DC 3.15V~6.3V)

No.MJ-097N

(center pin : 1.65 φ mm

I.D. : 5.15 φ mm)

JSAJ 3 (DC 6.3V~10.5V)

No.MJ-099N

(center pin : 1.3 φ mm

I.D. : 3.4 φ mm)

No.MJ-099N/3.8

(center pin : 1.3 φ mm

I.D. : 3.8 φ mm)

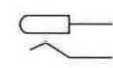
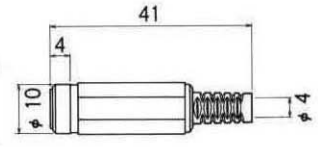

DC PLUG & JACK FOR EIAJ STANDARD No.RC-5322

No.MJ-300J

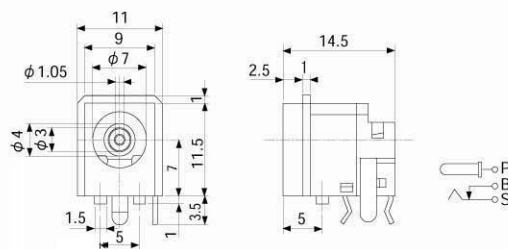

SNAP-IN DC JACKS

No.MJ60 (Center pin:2 φ mm)

No.MJ61 (Center pin:2.35 φ mm)

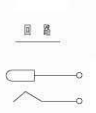
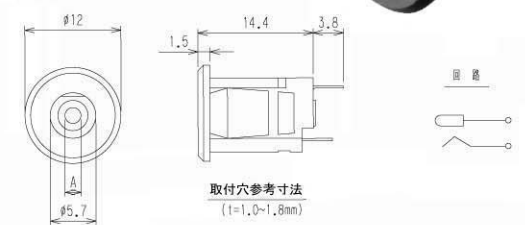

No.MP206

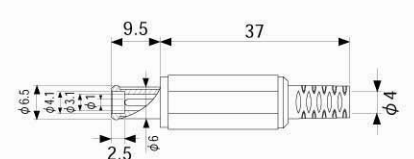

LOCKABLE DC SOCKETS & PLUGS

No.MJ-179LR

LOCKABLE DC SOCKET FOR P.C.B. (Center Pin : 2 φ mm)

TO MATE WITH MP-121CR

No.MJ-180LR

LOCKABLE DC SOCKET FOR P.C.B. (Center Pin : 2.35 φ mm)

TO MATE WITH MJ-122CR

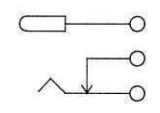

No.MP-121CR

DC PLUG WITH LOKING DETENT (5.5 φ mm × 2.1 φ mm)

TO MATE WITH MJ-179R

No.MJ-122CR

DC PLUG WITH LOKING DETENT (5.5 φ mm × 2.5 φ mm)

TO MATE WITH MJ-180R

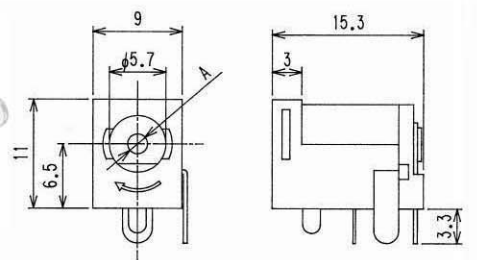
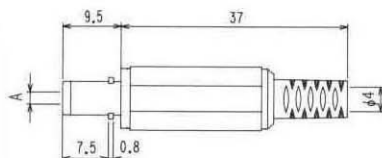

No.MP-121MR (5.5 φ mm × 2.1 φ mm)

DC PLUG WITH LOCKING DETENT FOR MOLDING

TO MATE WITH MJ179LR OR MJ10LR

No.MP-122MR (5.5 φ mm × 2.5 φ mm)

DC PLUG WITH LOCKING DETENT FOR MOLDING

TO MATE WITH MJ180LR OR MJ11LR

No.MJ10LR

LOCKABLE DC SOCKET FOR PANEL MOUNT (Center pin : 2 φ mm)

TO MATE WITH MP-121CR OR MP121MR

No.MJ11LR

LOCKABLE DC SOCKET FOR PANEL MOUNT (Center pin : 2.35 φ mm)

TO MATE WITH MP-122CR OR MP-122MR

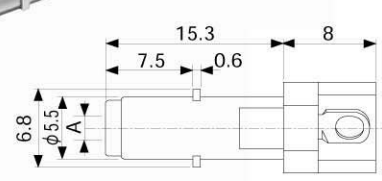
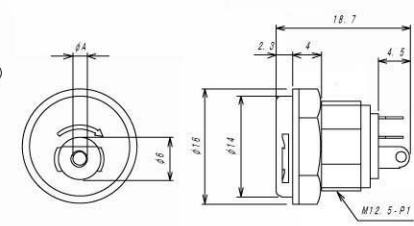

	A
MJ10LR	φ 2.0
MJ11LR	φ 2.35

