

INSIDE MICROMETERS

Inside Micrometers

Series 345, 145



345-711-30



145-187



145-193



300401 Cap

145-193
300400 Holder

A special holder is available for inside micrometers. The holder must be used with No. **156-101** MITUTOYO Stand or any other similar stand or vise available in the shop.

Features

- Accuracy to .0002" with graduations of .001".
- Easy zero adjustment.
- Clear graduations on satin-chrome finish.
- Caliper type jaws are made of high-grade, tool steel. They are satin-chrome finished.
- Locking clamp for positive locking of spindle.
- With ratchet thimble for constant force.
- Every thousandth is numbered for easy reading.
- Easily adjusted for slide movement of jaw (Exclusive.)
- Spanner wrench is supplied with every micrometer.
- Complete with fitted carrying case.
- Digimatic type features LCD Readout, Preset, Zero/ABS, Data/Hold, Inch/mm and SPC Output.

Specifications

Digimatic Inside Micrometers with Absolute Encoder

Inch/Metric

Order No.	LCD Range	Resolution	Accuracy	Remarks
345-711-30	.2"–1.18" 5–30mm	.00005" 0.001mm	±.0002"	with SPC output
345-712-30	1.0"–2.0" 25.4–50.8mm	.00005" 0.001mm	±.00025"	with SPC output

Metric

Order No.	Range	Resolution	Accuracy	Remarks
345-511-30	5–30mm	0.001mm	±0.005mm	with SPC output
345-512-30	25–50mm	0.001mm	±0.006mm	with SPC output

Note: Metric only Digimatic models have mm thimble and no inch/mm conversion function.

For SPC output order Connecting Cable **937387** (1m) or **965013** (2m). Replacement Battery: **541980** (1pc), **541980-10** (10pcs/SET).

INSIDE MICROMETERS

Inside Micrometers

Inch

Order No.	Range	Resolution	Accuracy	Remarks
145-193	.2"-1.18"	.001"	±.0002"	Measuring Face: A
145-194	1.0"-2.0"	.001"	±.00025"	Measuring Face: B
145-195	2.0"-3.0"	.001"	±.0003"	Measuring Face: C
145-196	3.0"-4.0"	.001"	±.00035"	Measuring Face: C

Metric

Order No.	Range	Resolution	Accuracy	Remarks
145-185	5-30mm	0.01mm	±0.005mm	Measuring Face: A
145-186	25-50mm	0.01mm	±0.006mm	Measuring Face: B
145-187	50-75mm	0.01mm	±0.007mm	Measuring Face: C
145-188	75-100mm	0.01mm	±0.008mm	Measuring Face: C

Measuring Face: A

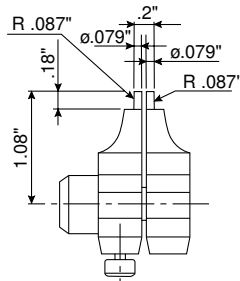

Measuring Face: B

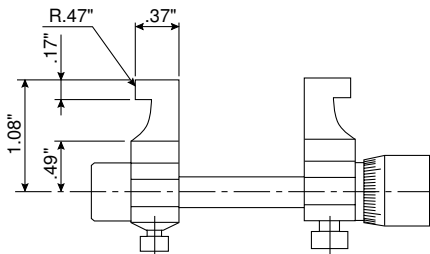

Digimatic Type Range .2-1.18"
(5-30mm)

Measuring Face: C

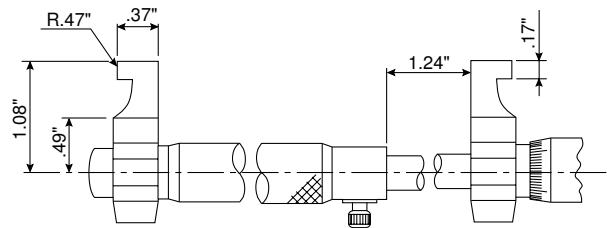

Digimatic Type Range 1-2"
(25-50mm)

